

# \$170,000 - 6801 50 Street, Rural Wetaskiwin County

MLS® #E4442880

**\$170,000**

0 Bedroom, 0.00 Bathroom,  
Rural on 0.92 Acres

Mulhurst Bay, Rural Wetaskiwin County, AB

Mulhurst Bay Opportunity! Nearly 1 acre of land (two separate lots) offering incredible potential just minutes from the shores of Pigeon Lake. These unserviced lots provide the perfect setting for your future cabin, year-round home, or weekend RV getaway. No timeline to build, and zoning allows for two RVs with a dwelling. Located under an hour from Edmonton with paved road access to the property line, the lots are surrounded by mature trees, offering privacy and a peaceful retreat. Power, gas, and other utilities are available at the property line. Enjoy everything this popular lake community has to offer: boating, fishing, golf, cycling, cross-country skiing, and the unique shops and restaurants in the Village at Pigeon Lake. Whether you're looking to build now or invest for the future, this is a rare opportunity in a sought-after location with plenty of room for your dream home and shop.

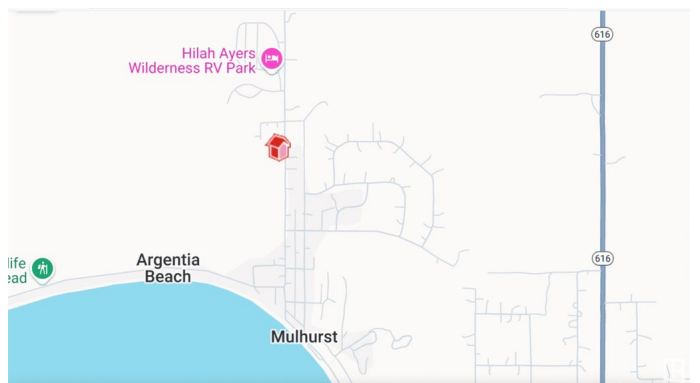
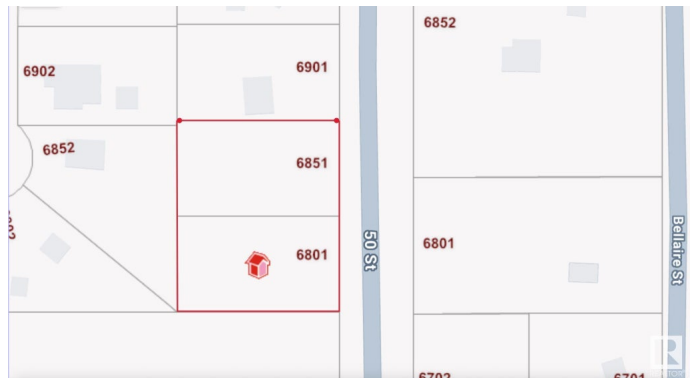

## Essential Information

MLS® #	E4442880
Price	\$170,000
Bathrooms	0.00
Acres	0.92
Type	Rural
Sub-Type	Vacant Lot/Land

Status Active

### Community Information

Address 6801 50 Street  
Area Rural Wetaskiwin County  
Subdivision Mulhurst Bay  
City Rural Wetaskiwin County  
County ALBERTA  
Province AB  
Postal Code T0C 2C0

### Exterior

Exterior Features Flat Site, Golf Nearby, No Back Lane, Playground Nearby

### Additional Information

Date Listed June 18th, 2025  
Days on Market 130  
Zoning Zone 95

DATA IS DEEMED RELIABLE BUT IS NOT GUARANTEED ACCURATE BY THE REALTORS® ASSOCIATION OF EDMONTON. COPYRIGHT 2025 BY THE REALTORS® ASSOCIATION OF EDMONTON. ALL RIGHTS RESERVED. Trademarks are owned or controlled by the Canadian Real Estate Association (CREA) and identify real estate professionals who are members of CREA (REALTOR®, REALTORS®) and/or the quality of services they provide (MLS®, Multiple Listing Service®)

Listing information last updated on October 26th, 2025 at 2:17pm MDT