

# \$50,000 - 5595 Nakamun, Rural Lac Ste. Anne County

MLS® #E4440813

**\$50,000**

0 Bedroom, 0.00 Bathroom,  
Rural on 0.65 Acres

Nakamun Park, Rural Lac Ste. Anne County,  
AB

Looking for the perfect summer escape? This prime corner lot is just steps from lake access—ideal for building your dream cabin and enjoying everything lake life has to offer. With power and gas at the property line, you're ready to start creating your retreat. Please note: RVs are not permitted, and all cabins must be a minimum of 800 sq ft, ensuring a well-maintained, cohesive community feel. Enjoy nearby picnic areas, parks, and a boat launch, perfect for boating, fishing, and relaxing with friends and family. Whether you're planning a weekend getaway or a seasonal sanctuary, this lot offers unmatched value, flexibility, and location—just 50 minutes from Edmonton, 45 from Spruce Grove, and 20 to Onoway. Affordable, accessible, and packed with potential—don't miss your chance to invest in the lake lifestyle you've been dreaming of!

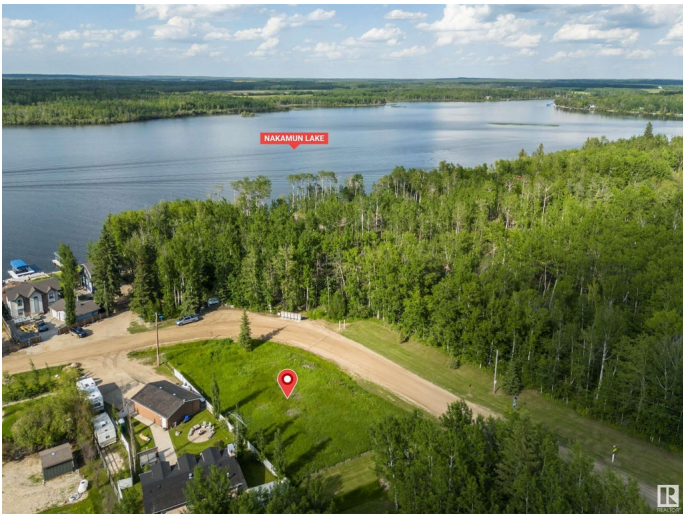
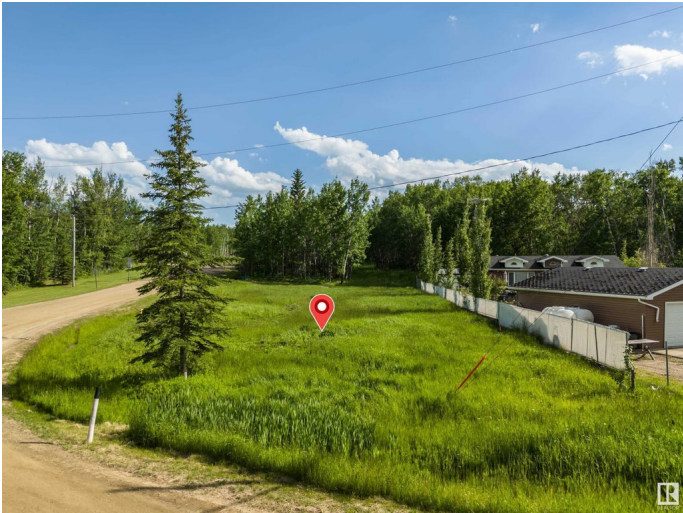
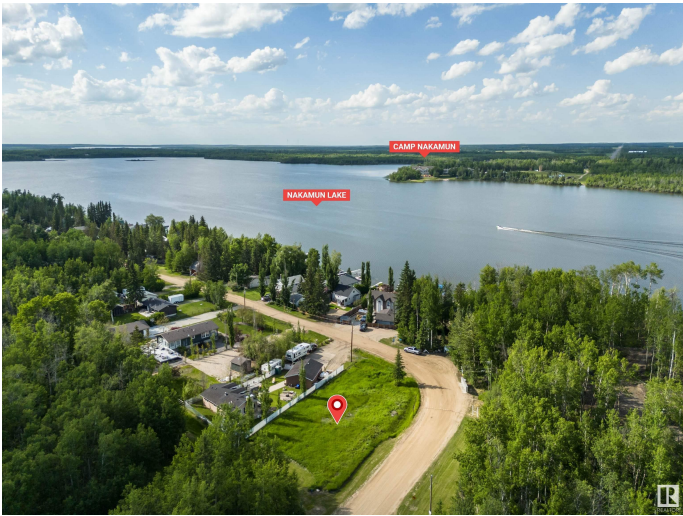

## Essential Information

MLS® #	E4440813
Price	\$50,000
Bathrooms	0.00
Acres	0.65
Type	Rural

Sub-Type	Vacant Lot/Land
Status	Active

### Community Information

Address	5595 Nakamun
Area	Rural Lac Ste. Anne County
Subdivision	Nakamun Park
City	Rural Lac Ste. Anne County
County	ALBERTA
Province	AB
Postal Code	T0E 1V0

### Exterior

Exterior Features	Beach Access, Boating, Corner Lot, Lake Access Property, Lake View, Playground Nearby, See Remarks
-------------------	--

### Additional Information

Date Listed	June 6th, 2025
Days on Market	81
Zoning	Zone 73

DATA IS DEEMED RELIABLE BUT IS NOT GUARANTEED ACCURATE BY THE REALTORS® ASSOCIATION OF EDMONTON. COPYRIGHT 2025 BY THE REALTORS® ASSOCIATION OF EDMONTON. ALL RIGHTS RESERVED. Trademarks are owned or controlled by the Canadian Real Estate Association (CREA) and identify real estate professionals who are members of CREA (REALTOR®, REALTORS®) and/or the quality of services they provide (MLS®, Multiple Listing Service®)

Listing information last updated on August 26th, 2025 at 10:02am MDT