

\$799,000 - Rr241 Twp 585, Rural Westlock County

MLS® #E4398231

\$799,000

0 Bedroom, 0.00 Bathroom,
Rural on 160.00 Acres

None, Rural Westlock County, AB

Great opportunity to own a quarter section of farm land in Westlock county. This property has two 80 acre parcels (separate titles) currently in pasture land for Cattle. Property is fenced and is currently grazing cattle. Excellent opportunity for cereal crop land development into seed-able acres. Conveniently located close to pavement (Lily Lake Road).

Essential Information

MLS® #	E4398231
Price	\$799,000
Bathrooms	0.00
Acres	160.00
Type	Rural
Sub-Type	Vacant Lot/Land
Status	Active

Community Information

Address	Rr241 Twp 585
Area	Rural Westlock County
Subdivision	None
City	Rural Westlock County
County	ALBERTA
Province	AB
Postal Code	T0G 1L2

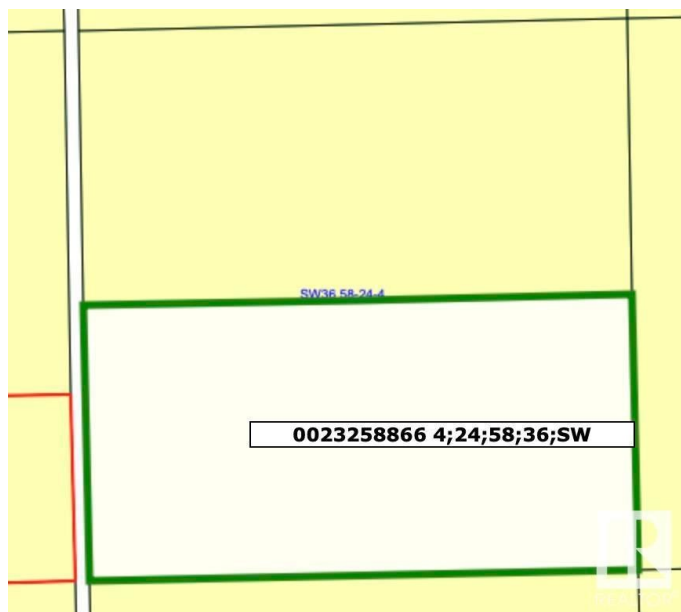

Exterior

Exterior Features Fenced

Additional Information

Date Listed July 18th, 2024
Days on Market 286
Zoning Zone 60

DATA IS DEEMED RELIABLE BUT IS NOT GUARANTEED ACCURATE BY THE REALTORS® ASSOCIATION OF EDMONTON. COPYRIGHT 2025 BY THE REALTORS® ASSOCIATION OF EDMONTON. ALL RIGHTS RESERVED.Trademarks are owned or controlled by the Canadian Real Estate Association (CREA) and identify real estate professionals who are members of CREA (REALTOR®, REALTORS®) and/or the quality of services they provide (MLS®, Multiple Listing Service®)
Listing information last updated on April 30th, 2025 at 3:17pm MDT